

CLERMONT AUVERGNE PATINAGE ARTISTIQUE PRÉSENTE

COUPE INTERNATIONALE DES VOLCANS

DE BALLET SUR GLACE



09 MARS
20**24**

Place 5€

Entrée libre pour les moins de 10 ans



PATINOIRE PAPADAKIS & CIZERON

155 BD GUSTAVE FLAUBERT, 63000 CLERMONT-FERRAND



CSN
BALLET
SUR GLACE



LIGUE
AUVERGNE
RHÔNE ALPES



La Région
Auvergne-Rhône-Alpes

PUY-de-DÔME
MON DÉPARTEMENT

+ clermont
auvergne
métropole



CSN
BALLET
SUR GLACE

Coupe Internationale Des Volcans

Patinoire Gabriella PAPADAKIS & Guillaume CIZERON

Dear Madam,

Dear Sir,

The Clermont Auvergne Figure Skating club is pleased to invite you to:

Coupe Internationale des Volcans

Which will take place at Clermont Ferrand at the Ice Rink

Gabriella PAPADAKIS & Guillaume CIZERON

Saturday March 9, 2024

You will find attached the presentation file for this competition.

We look forward to seeing you at this event.

Francisque MARLIAC

President of C.A.P.A

Odeline BISSON, Carine

MARLIAC & Gaëtan ROY

Organizing Committee



CSN
BALLET
SUR GLACE

Coupe Internationale Des Volcans

Gabriella PAPADAKIS & Guillaume CIZERON Ice Rink

CLERMONT FERRAND



www.clermont-ferrand.fr



The modernization of the road and motorway networks carried out to reach the Auvergne capital has offered Clermont Ferrand a renewed interest in the many attractions it offers.

Founded in 1630 by King Louis XIII who then brought together Clermont, an ancient city and Montferrand, a medieval city, it is located at the heart of the Paris/Barcelona and Lyon/Bordeaux axes. It represents an ideal center for human, cultural encounters and economic exchanges.

The Chaîne des Puys, whose highest point is the Puy de Dôme at 1465 m, is the base of a volcanic culture and nature which are found in exceptional landscapes and architecture which attract ever more pilgrims and tourists.

Its Basilica “Notre Dame du Port” as well as its chain of Puys – Limagne fault are classified as UNESCO world heritage sites.

The hospitable reputation of the Auvergne city, birthplace of Blaise Pascal, who proclaimed that “every human aspires to happiness” is also due to its local products, capable of satisfying the most demanding epicureans.

Its semi-continental climate helps make it a popular destination in all seasons.

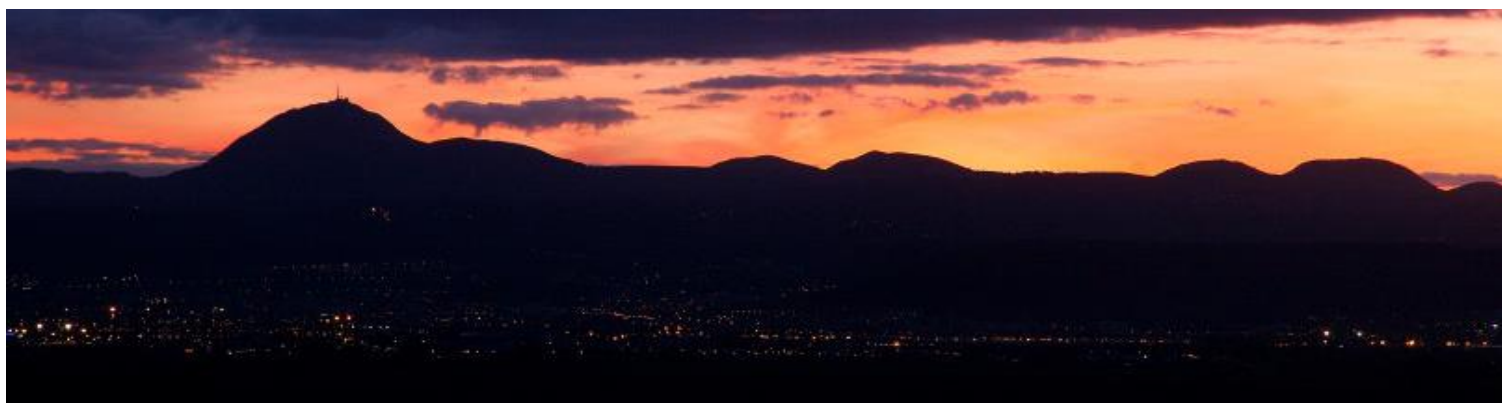

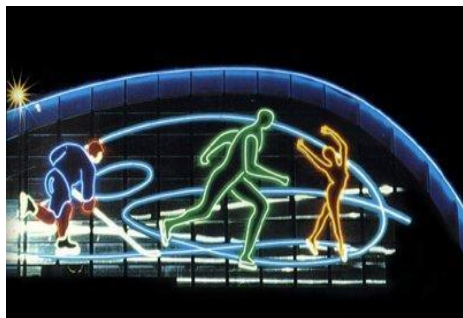

**The Marcel-Michelin Stadium,
The Gabriel-Montpied Stadium,
The sports house,
The Coubertin swimming pool**



The Gabriella PAPADAKIS & Guillaume CIZERON ice rink with an Olympic rink.

There are many different access points to the city:

By road :

Clermont-Ferrand is served by A75, A89 and A71 motorways.

By train :

Direct daily connections with major cities in France (Paris, Lyon...)

By plane :

Located at Aulnat, 6 km from the city center, Clermont international airport indirectly serves more than 230 daily destinations.

Inside the city:

Travel in the city is made easier by the tram and buses of T2C network.

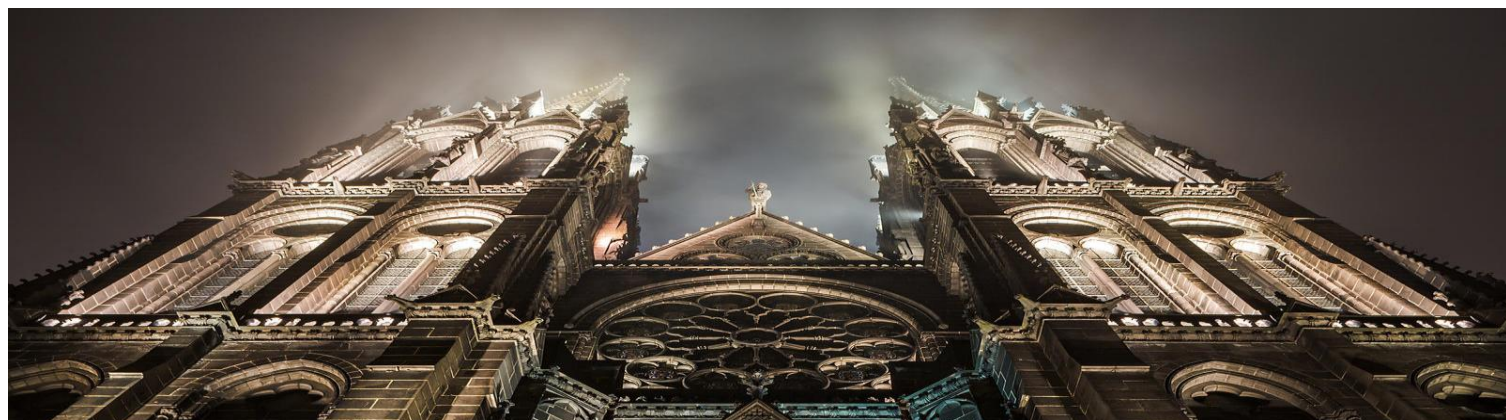



Coupe Internationale Des Volcans

Gabriella PAPADAKIS & Guillaume CIZERON Ice Rink

Features of the rink

Gabriella PAPADAKIS & Guillaume CIZERON Ice Rink

155 Boulevard Gustave Flaubert

63000 CLERMONT –FERRAND

The dimensions of the ice rink are: 60 m x 30 m

The ice rink has 1,150 places for spectators (jury deducted).

LOCKER ROOMS:

1 large locker room at 600m from the ice rink

4 club changing rooms with showers and toilets

1 large public locker room

Toilets and showers are available to skaters inside the rink. All changing room access areas will be badge-controlled.

PARKING:

Ice rink parking: more than 150 spaces.

If necessary, parking spaces for buses will be reserved by municipal decree inside the ice rink parking and behind the ice rink depending on the number. Please let us know when registering.



Coupe Internationale Des Volcans

Gabriella PAPADAKIS & Guillaume CIZERON Ice Rink

Map of Clermont-Ferrand and access to the Ice Rink

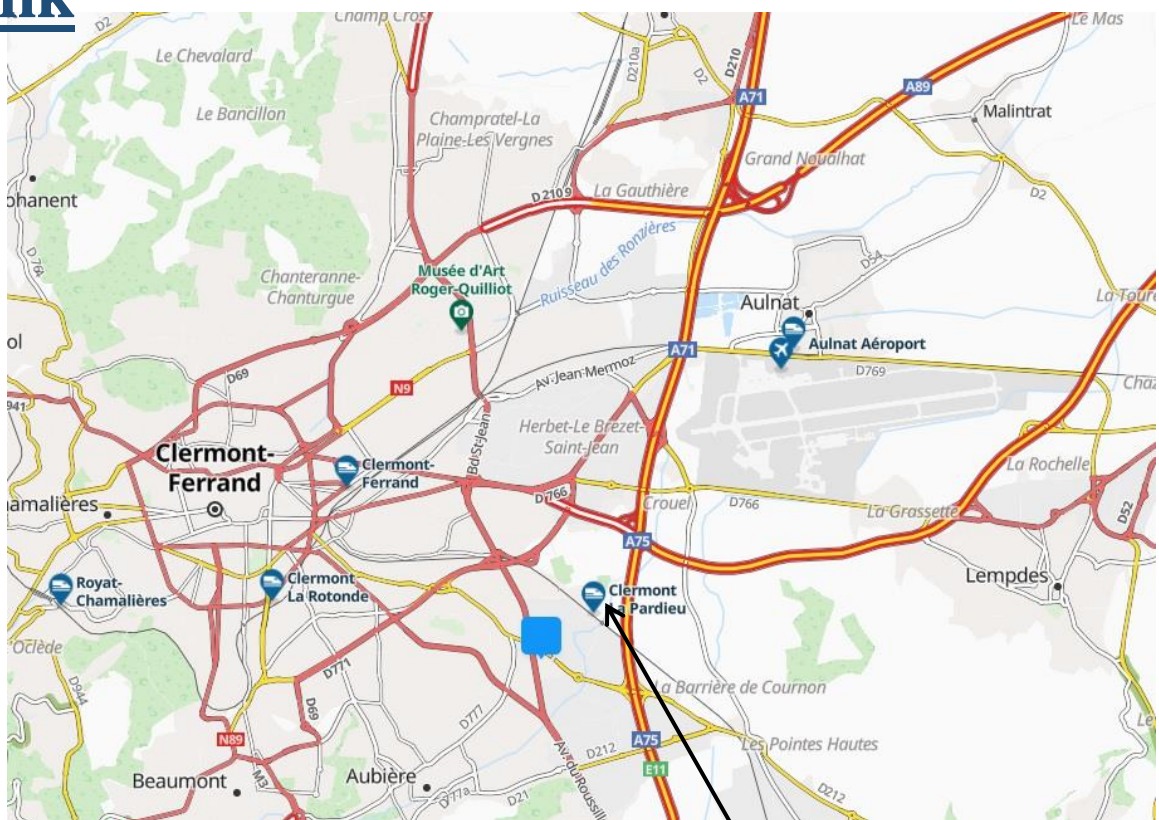

PATINOIRE

CAR :

From PARIS A71 motorway => Exit 1 La Pardieu

LYON A89 motorway => A711 => Exit 1 La Pardieu

TRAIN :

SNCF Station of Clermont-Ferrand (5,3 km from the ice rink)

SNCF Station La Pardieu (600m from the ice rink)

TRAM :

Line A, stop Lycée Lafayette



Coupe Internationale Des Volcans

Gabriella PAPADAKIS & Guillaume CIZERON Ice Rink

Ice Rink ground floor

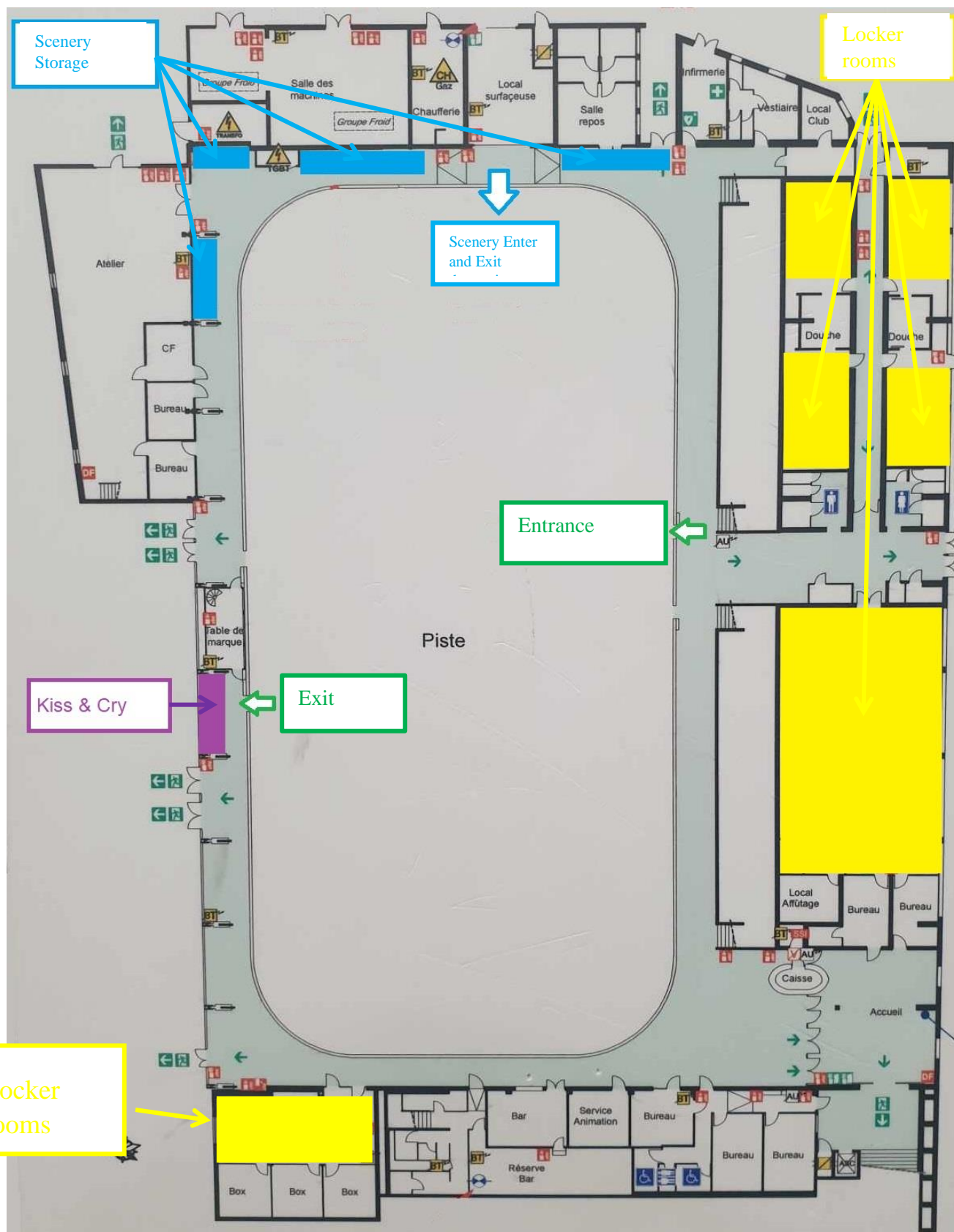



CSN
BALLET
SUR GLACE

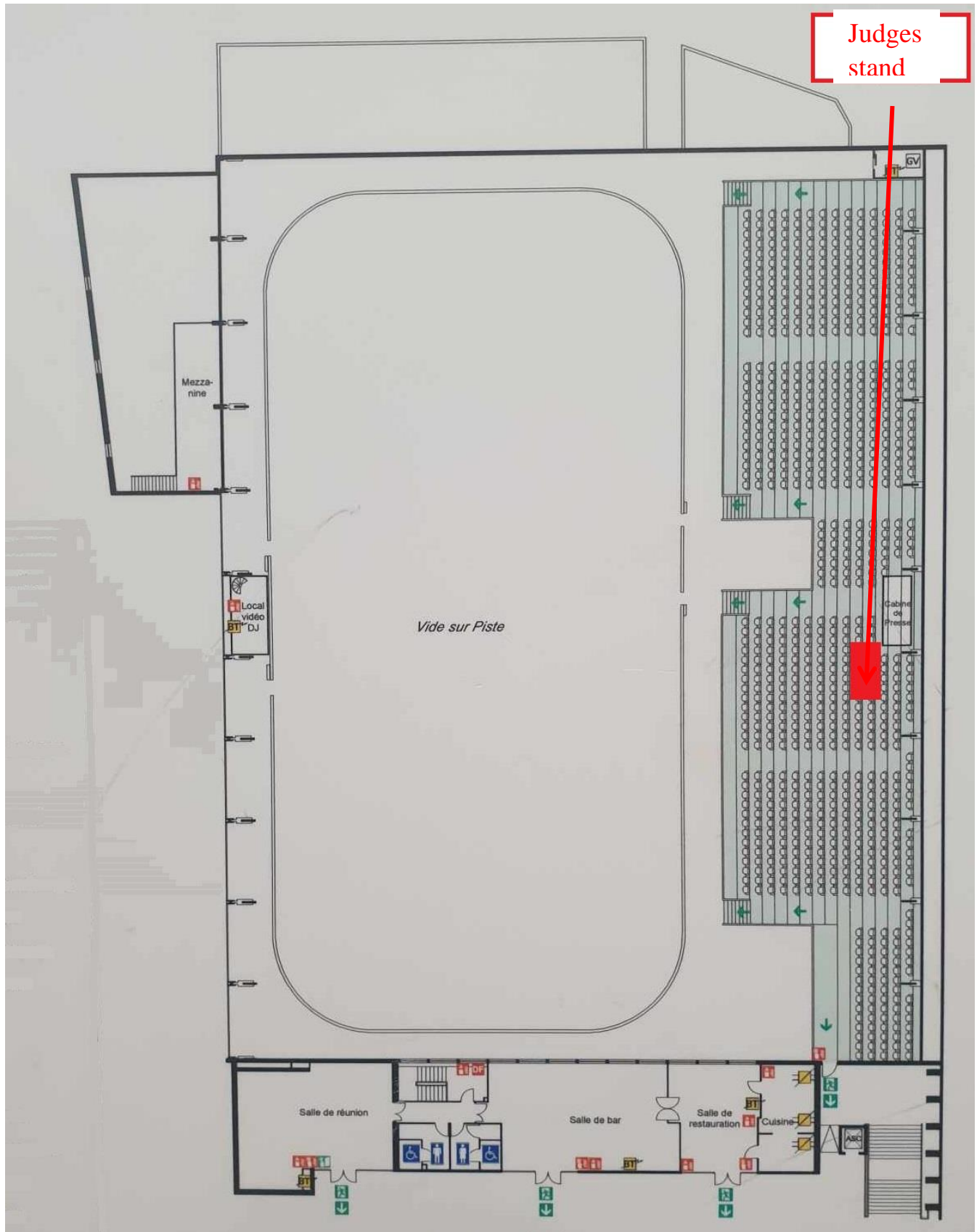



Coupe Internationale Des Volcans

Gabriella PAPADAKIS & Guillaume CIZERON Ice Rink

Competition rules

Guest list :

All members of the International Skating Union are invited to participate in the Coupe des Volcans.

Categories:

The competition is open to the following categories: Senior, Junior, Novice, Adult, Open + 15 years old, Open – 15 years old, Open Mixed Age.

The age categories and regulations applying to this competition are those established by the CSN Ballet available on the website:

<https://www.csnballet.org/téléchargements/règlement/>.

Choreographic exercise:

Reminder of Choreographic Elements for 2024 season:

Theme: [Street Art](#)

Choreographic process: [Contrast](#)

Gesture: [Release](#)



Coupe Internationale Des Volcans

Gabriella PAPADAKIS & Guillaume CIZERON Ice Rink

Registrations:

The registration price is 200 euros per participating team.

Payment to CAPA must be by bank transfer no later than the registration deadline (bank transfer costs are the responsibility of the participating clubs).

Team registration will only be valid upon receipt of payment of registration fees.

Registration fees and/or any reservations will not be refunded if the withdrawal occurs less than 8 weeks before the competition.

Deadline for registration and payment: December 15, 2023

SOCIETE GENERALE		RELEVÉ D'IDENTITÉ BANCAIRE	
Titulaire du Compte :	CLERMONT AUVERGNE PATINAGE ARTISTIQ PATINOIRE 155 BOULEVARD GUSTAVE FLAUBERT 63000 CLERMONT FERRAND		
Domiciliation	COURNON D'AUVERGNE		(00643)
Identification nationale (RIB)			
30003	00640	00037270259	08
Code Banque	Code Guichet	Numéro de Compte	Clé RIB
Identification internationale (IBAN)			
IBAN FR76 3000 3006 4000 0372 7025 908			
Identifiant international de la Banque (BIC)			
SOGEFRPP			



Coupe Internationale Des Volcans

Gabriella PAPADAKIS & Guillaume CIZERON Ice Rink

Music

The music must be sent in advance by Email in MP3 format to the following address:

capacompetition63@gmail.com

Only one music file per Email. The subject of the email must include the name of the category, type of program and the name of the team.

Recordings in USB format must be provided at the time of accreditation. These must be of excellent quality, 2 copies for each program (choreographic exercise and free ballet).

Each USB key must be stored in a box or case and be identified with the name of the team, the category, the type of program and the exact duration of the music.

Photo of the team and text of Choreographic Exercise and Free Ballet

In order to prepare the competition program, we ask you to send us by email a photo of the team as well as the text of the choreographic exercise and ballet free to : capacompetition63@gmail.com

Scenery

We thank you for kindly specifying the volume of your team's scenery (in cubic meters) in order to organize their unloading/loading in the "Scenery" area. Only people with a "Scenery" accreditation will be able to access this area.

Music, texts and photos must be sent before February 4, 2024



Coupe Internationale Des Volcans

Patinoire Gabriella PAPADAKIS & Guillaume CIZERON

Tentative Schedule

Friday March 8, 2024:

- Unofficial training sessions can be booked on Friday afternoon.

Booking on request. Price for 30 min: 50 euros

Bookings must be made no later than December 30, 2023.

- 7pm to 9pm : Official Training sessions

Saturday March 9, 2024

- 7:00 a.m. to 1:00 p.m.: Official training session
- 1:00 p.m. to 2:00 p.m.: Meal break
- 2:00 p.m. to 2:30 p.m.: Opening ceremony / Teams presentation
- 2:30 p.m. to 4:00 p.m.: Choreographic Exercise
- 4:00 p.m. to 8:00 p.m.: Free ballet
- 8:15 p.m.: Awards

This schedule will be adjusted according to the number of registered teams and their category. It will be sent before the competition.

Teams are required to be present 30 minutes before their appearance.

The organizing committee reserve the right to keep any advance schedule during the competition.



Coupe Internationale Des Volcans

Gabriella PAPADAKIS & Guillaume CIZERON Ice Rink

Event Organization

Upon arrival, you will be given for each team:

- 1 President accreditation
- 1 Coach accreditation
- 1 Choreographer accreditation
- 2 Scenery accreditations
- 1 team manager accreditation

Per additional team:

- 1 Scenery accreditation
- 1 team manager accreditation

For security reasons, only people with an accreditation will be able to access the changing rooms, the scenery area and the entrance ice track .

Entrance to the ice rink for visitors will be 5 euros for people over 10 years old and free for children under 10 years old.

Welcoming the teams :

The reception desk will be at your disposal as soon as you arrive at the ice rink. A locker room manager will follow you throughout the day to guide you through the competition.

Medical service :

A medical service will be in place throughout the competition.

An anti-doping control may take place. It will be carried out in accordance with the rules and procedures



Coupe Internationale Des Volcans

Gabriella PAPADAKIS & Guillaume CIZERON Ice Rink

Hotels

- Hôtel Restaurant Campanile Clermont-Ferrand Sud – Aubière ***

ZAC des Varennes Est, Av. Lavoisier, 63170 Aubière

Phone : 04 73 27 90 00

- Kyriad Clermont-Ferrand-Sud - La Pardieu ***

9 Rue de l'Eminée, 63000 Clermont-Ferrand

Phone : 04 73 28 24 24

- ACE Hôtel Clermont-Ferrand / La Pardieu ***

Rue de l'Eminée, 63000 Clermont-Ferrand

Phone : 04 73 44 73 44

- Brit Hotel Essentiel Arverne **

20 Av. Lavoisier, 63170 Aubière

Phone : 04 73 28 01 66

- Hôtel ibis budget Clermont Ferrand Sud Aubière **

Cap Sud, 22 Av. Lavoisier, 63170 Aubière

Phone : 08 92 68 31 98

- B&B HOTEL Clermont-Ferrand Sud Aubière **

28 Av. Lavoisier, 63170 Aubière

Phone : 08 90 64 97 18

- The Originals City, Hôtel Clermont-Ferrand Sud Aubière (P'tit Dej-Hotel) **

8 Av. Lavoisier, 63170 Aubière

Phone : 04 73 28 38 48



**CSN
BALLET
SUR GLACE**

Coupe Internationale Des Volcans

Gabriella PAPADAKIS & Guillaume CIZERON Ice

Rink

Restaurants partners of the competition

Brasserie of the Ice Rink HBF:

155 Boulevard Gustave Flaubert 63000 Clermont-Ferrand

Phone : 09 83 43 20 89 / 06.65.37.43.30

To serve you better, it is recommended to book in advance.

Menu 1 dish + 1 dessert + 1 coffee for 15 euros

Choice among:

- Hot Dog with fries (raw vegetables, ketchup, mustard, crispy onions)
- Pokeball (chicken breast + raw vegetables + salad)
- Cheesecake
- Apple crumble

Le Beaupré La Pardieu

Cafétéria du Leclerc

175 Bd Gustave Flaubert

Phone : 04 73 44 29 03

Flunch :

140 Boulevard Gustave Flaubert, 63000 Clermont-Ferrand

Phone : 04 73 16 08 39

10% discount on
presentation of the
competition
program